

Smart WIFI LED Ceiling Light with AI User Manual

Bluetooth Speaker Function: Just connect the Device with Bluetooth to enjoy Wireless Music from your smart phones/tablets. (Important: Please avoid changing lights from APP or Remote when the music is playing in speaker. Just choose the Light & then play music via Bluetooth)



Echo



Google Home

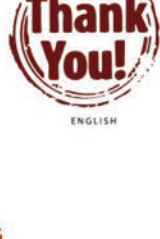

Specification

No.	Item	Parameter
	Input Voltage (V)	100-240V / (50-60Hz)
	Input Power (W)	< 24W / (36W)
	Size (MM)	Φ405 H110 / Φ360 H110
Light	CRI	White > 0.85; Warm white > 0.85
	Luminous flux (LM)	> 2120
	Color temperature (K)	2800-6000, tolerance: ± 250K
	Light decay	< 10%, T=25°C; RH=90%; H=20000
	Dimming	PWM from 10-100% brightness

Installation type A:



Fix fixture to ceiling with screws. Push lamp into fixture with hands. Connect AC cable to the terminal

Installation type B:

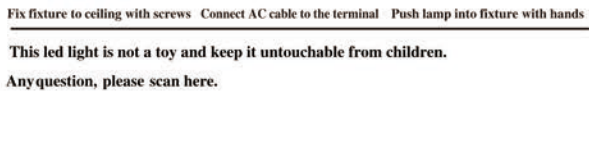

Fix fixture to ceiling with screws. Connect AC cable to the terminal. Push lamp into fixture with hands.

This led light is not a toy and keep it untouchable from children.

Any question, please scan here.

Smart WIFI LED Ceiling Light with AI User Manual

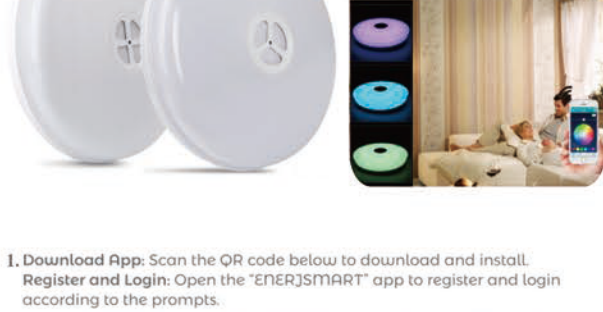

1. Download App: Scan the QR code below to download and install. Register and Login: Open the "ENERJSMART" app to register and login according to the prompts.

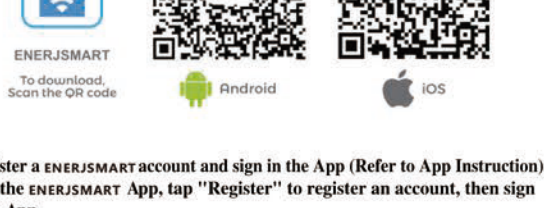

2. Register a ENERJSMART account and sign in the App (Refer to App Instruction). Open the ENERJSMART App, tap "Register" to register an account, then sign in the App.

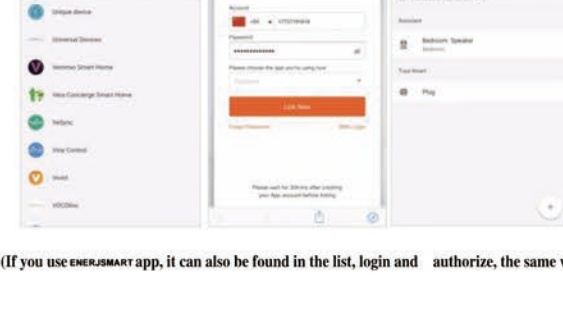

(If you use ENERJSMART app, it can also be found in the list, login and authorize, the same way)

Now you can control your smart devices through Google Home. Take bedroom light as an example, the supported voice commands are as below:

- Ok Google, on/off bedroom
- Ok Google, set bedroom light to 50 percent.
- Ok Google, brighten bedroom light.
- Ok Google, dim bedroom light.
- Ok Google, set bedroom light to red.

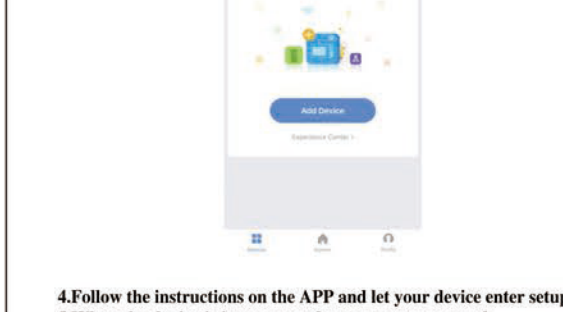

3. Add new device.

4. Follow the instructions on the APP and let your device enter setup mode. 5. When the device is in setup mode, tap next to proceed.

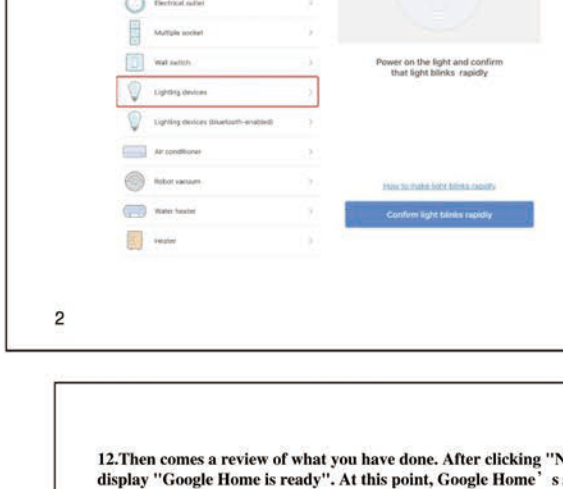

3.2 Link ENERJSMART account in Home Control

ATTENTION: Due to the Google Home app's known bug, you could only use one Google account to control "Home Control Action". If you sign in Google Home app with several Google accounts, only the first Google account you signed in can be used for "Home Control".

1. Tap "Home Control" in the hamburger menu on the Google Home app's home page, then tap "+".

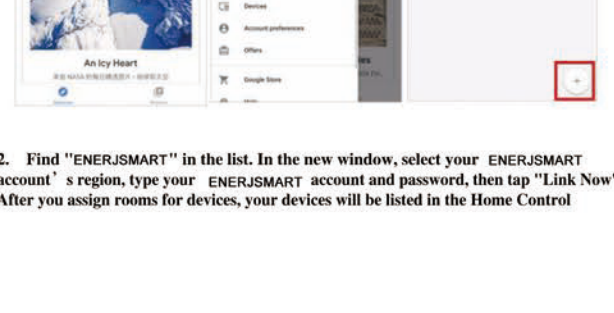

2. Find "ENERJSMART" in the list. In the new window, select your "ENERJSMART account" 's region, type your "ENERJSMART" account and password, then tap "Link Now". After you assign rooms for devices, your devices will be listed in the Home Control

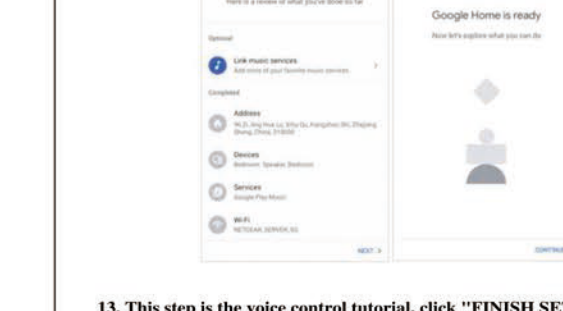

13. This step is the voice control tutorial, click "FINISH SET UP".

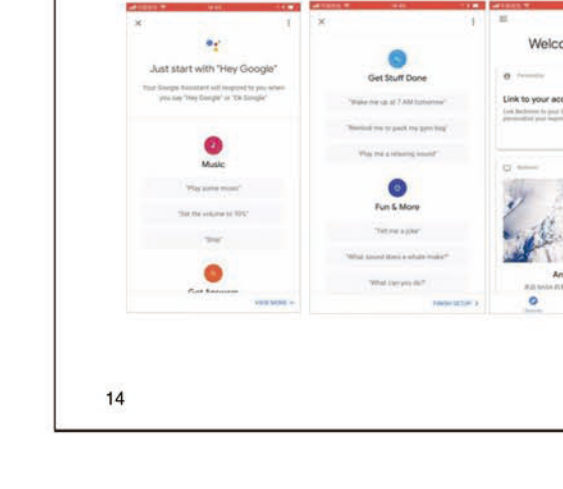

6. Enter the SSID and password of the network. After confirming the SSID and password, tap "Confirm" to start the setup. 7. You need to wait for the network configuration until it succeeds.

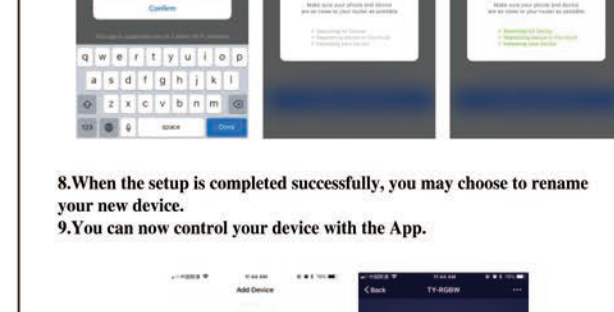

8. When the setup is completed successfully, you may choose to rename your new device. 9. You can now control your device with the App.

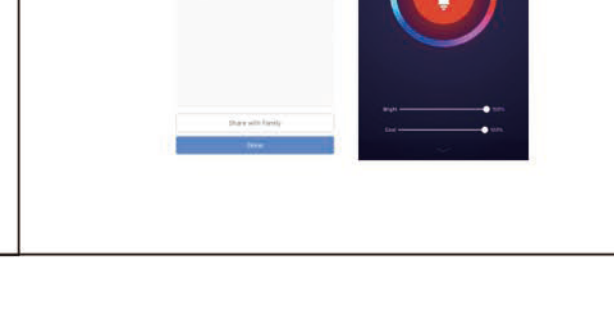

Quick Guide of Using Amazon Echo to Control Smart Devices

1. What you need to get started Before using Echo to control your smart devices, make sure you meet the following conditions.

- 1. Stable Wi-Fi network which could access to Amazon server. (China Mainland users)
- 2. An Echo device, including Echo, Echo Tap, or Echo Dot.
- 3. An Amazon account.
- 4. ENERJSMART App and a related account.
- 5. Smart devices.

2. Add devices in ENERJSMART App (Refer to App Instruction) ENERJSMART You can skip this part if you've already added some devices to your account, and in the meantime the devices' name are easily recognized.

2.1 Register a ENERJSMART account and sign in the App (Refer to App Instruction) Open the ENERJSMART App, tap "Register" to register an account, then sign in the App.

2.2 Add device and change device's name (Refer to App Instruction) Sign in with the ENERJSMART account, add the device, then change device name to a easily recognized word or phrase, like "bedroom light".

3. Set up Amazon Echo and configure ENERJSMART Skill We suggest using web for configuration in China mainland since Alexa App is not available here.

User can configure Echo through web or Alexa App. Web configuration link: <http://alexa.amazon.com/spa/index.html> Search "Amazon Alexa" in App Store or Google Play to install the App. We take App configuration as an example. Configuration through web and App are basically the same.

9. Select a language, then click "Next". 10. Waiting for the system to set up your Google Assistant automatically, click "Next".

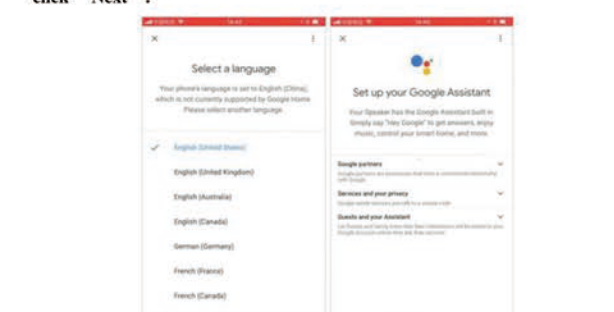

11. Click "I AGREE" to allow Google Home to get your calendar, Light itinerary, and more to provide personalized customization. Then set your geographic location, select the music service you need, and click on "NEXT". If you don't need it, you can click "Not Now" to skip.

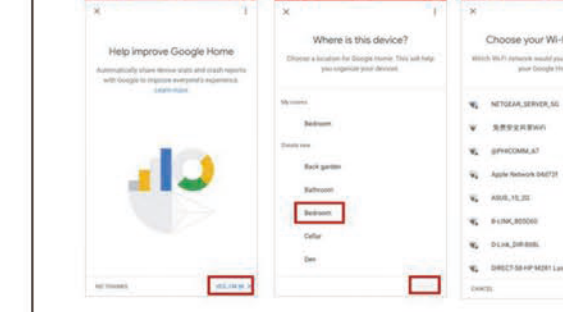
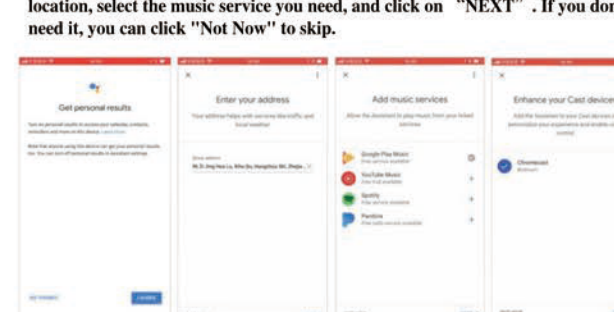

8. After successfully connected, the APP page will display as follows.

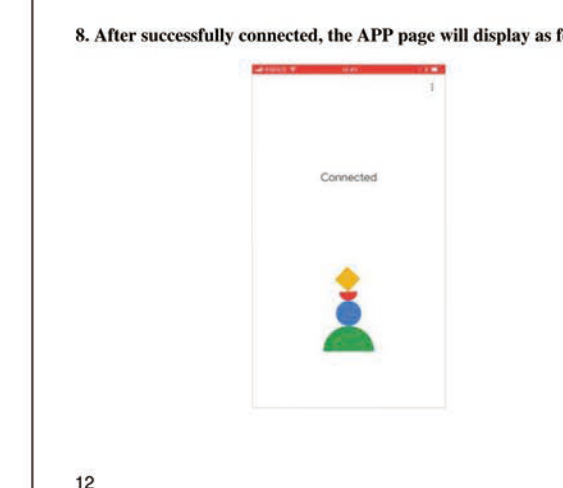

3.1 Set up Echo with Alexa App

You can skip this part if your Echo is already set up. 1. Make sure your Echo device is energized. 2. Make sure Echo is in a Wi-Fi network that can access Amazon services smoothly. 3. Open the Alexa App by tapping the App icon on your mobile device. 4. Type in your Amazon account and password, then tap "SIGN IN".

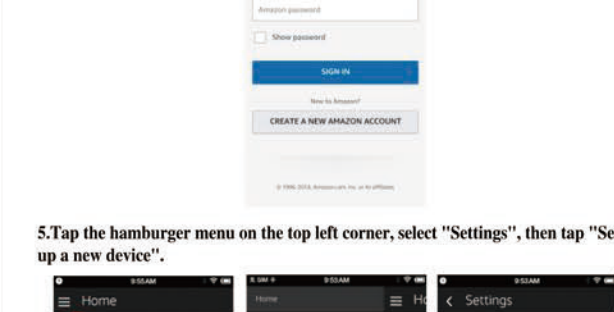

5. Tap the hamburger menu on the top left corner, select "Settings", then tap "Set up a new device".

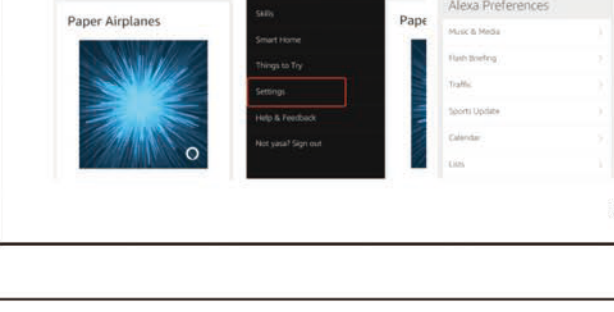

6. Select your Echo model, choose a proper language, then tap "CONNECT TO WI-FI".

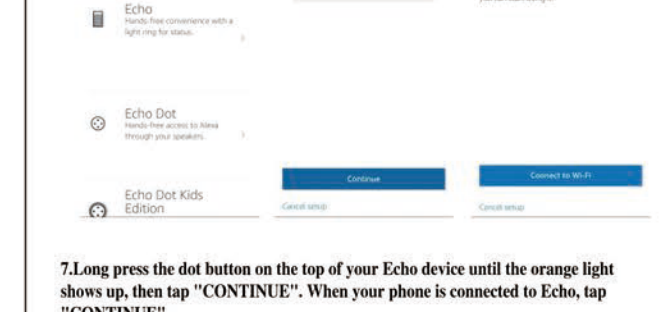

7. Long press the dot button on the top of your Echo device until the orange light shows up, then tap "CONTINUE". When your phone is connected to Echo, tap "CONTINUE".

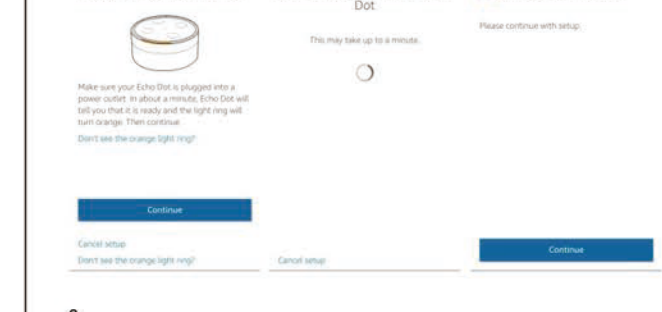

3.1 Set up Google Home with Google Home App

You can skip this part if your Google Home is already set up. 1. Make sure your Google Home is energized and four colored lights on the top are on which means that it is in a state of waiting for a connection. 2. Make sure Google Home is in a Wi-Fi network that has smooth access to Google services. 3. Open the Google Home app, the device will automatically appear in the "Discover" page. 4. Click "SET UP" to start connecting to Google speakers and click "YES" after you hear the voice prompts.

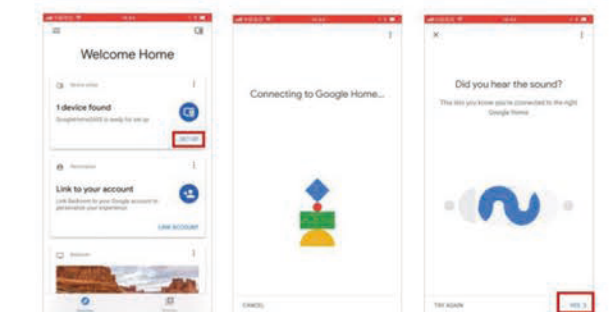

5. Help improve Google Home and click "YES, I'M IN" in the lower right corner. 6. Choose a location for Google Home, for example, choose "bedroom". 7. Choose your Wi-Fi network to set up your Google Home.

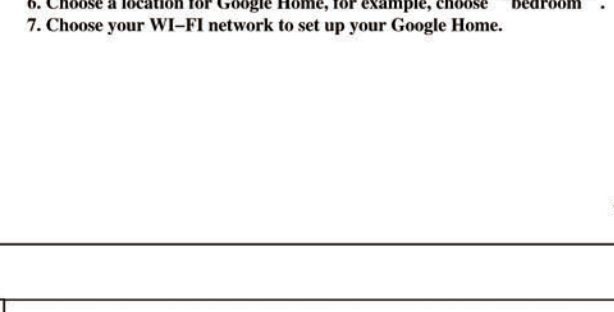

Quick Guide of Using Google Home to Control Smart Devices

1. What you need to get started Before using Google Home to control your devices, make sure you meet the following conditions.

- ✓ A Google Home device, or Android phone with Google Assistant.
- ✓ Latest Google Home App.
- ✓ Latest Google App (Android only)
- ✓ A Google account.
- ✓ The device display language must be set to English US.
- ✓ ENERJSMART App and a related account.
- ✓ Smart devices.

2. Add devices in ENERJSMART App (Refer to App Instruction) You can skip this part if you've already added some devices to your ENERJSMART account, and in the meantime the devices' name are easily recognized.

2.1 Register a ENERJSMART account and sign in the App (Refer to App Instruction) Open the ENERJSMART App, tap "Register" to register an account, then sign in the App.

2.2 Add device and change device's name (Refer to App Instruction) Sign in with the ENERJSMART account, add the device, then change device name to a easily recognized word or phrase, like "bedroom light".

3. Set up Google Home and configure in Home Control Configuration needs Google Home App. Search "Google Home" in App Store or Google Play to install the App.

8. Select a Wi-Fi to let Echo have the access to the internet. Type in the Wi-Fi password, then tap "CONNECT". Echo may take several minutes to connect to the network.



9. Tap "CONTINUE" when Echo is connected to the network. After an introduction video, tap "CONTINUE" to finish the setup.

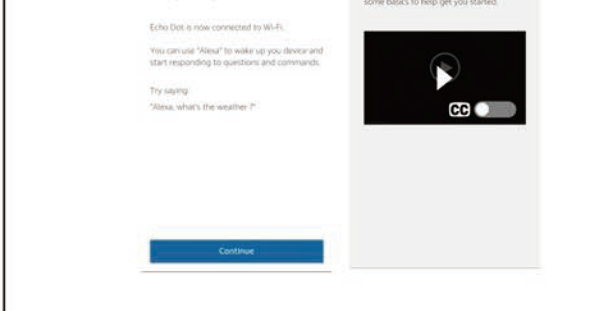

3.2 Link ENERJSMART account to Alexa

1. Tap "Skills" in the hamburger menu, then search "ENERJSMART". Select "ENERJSMART" and tap "ENABLE" to enable the Skill.

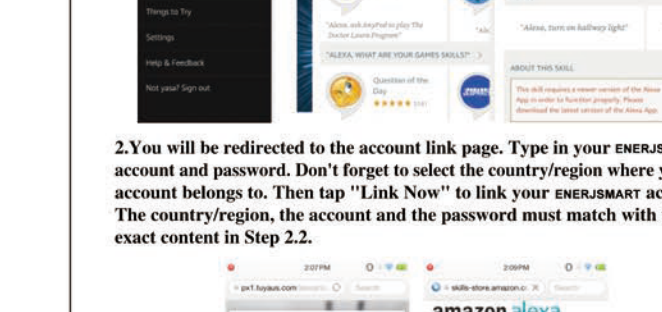

2. You will be redirected to the account link page. Type in your ENERJSMART account and password. Don't forget to select the country/region where your account belongs to. Then tap "Link Now" to link your ENERJSMART account. The country/region, the account and the password must match with the exact content in Step 2.2.



4. Control your smart devices through Echo

4.1 Discover devices

Echo needs to discover your smart devices before it controls them. You can say "Alexa, discover devices" to the Echo. Echo will discover devices which have already been added in the ENERJSMART app. You can also tap "DISCOVER" to discover the smart devices. Discovered devices will be shown in the list.

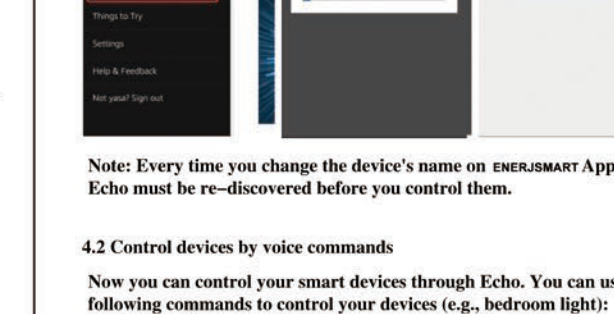

Note: Every time you change the device's name on ENERJSMART App, Echo must be re-discovered before you control them.

4.2 Control devices by voice commands

Now you can control your smart devices through Echo. You can use the following commands to control your devices (e.g., bedroom light):

- Alexa, set bedroom light to 50 percent.
- Alexa, brighten/dim bedroom light.
- Alexa, set bedroom light to green.
- Alexa, set bedroom light to warm white.