



ENER-J®

Smart Home Living

LED HIGH BAY LIGHT

Linear III High Bay



CRI
>70(80)



3000K

4300K

5700K

CCT SWITCHABLE

SKU CODE:

T756

T757

T758

Packing

Inner packing Qty

1 pc/ Box

Outer Carton Packing Qty

4 sets/Carton

Key Features

- Max Efficiency 150 Lm/W
- Multiple Light Distribution
- Pendant and Pole Mounting Installation
- Built in driver

Technical Parameters

► OPTICAL SPECS

Lumen Efficacy	150 Lm/w
CCT	3000K, 4300K, 5700K
CRI	>70 (80)

► ELECTRICAL SPECS

Power	100W (T756), 150W (T757), 200W (T758)
Input Voltage	AC220~240 Volts
Power Frequency	50/60 Hz
Power Factor	>0.95
Total Harmonic Distortion	<15%(@230V)
Insulation Grade	Class I

► OTHER DETAILS

Lifespan	≥50,000 Hours
Operating Temperature	-30°~50°C
Structure	Extruded 6063AL
LED Spec	SMD2835

► MECHANICAL SPECS

Color	Black / White
Lens	Polycarbonate
Ingress Protection	IP42
Impact Resistance	IK10
Material	Housing: 6063 Aluminum Cover: Polycarbonate Screws: Stainless

LIGHT DISTRIBUTION CURVE

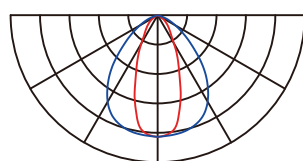

(30°x90°)

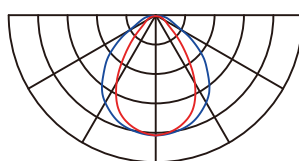

(60°x110°)

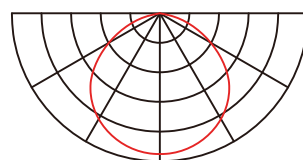

120°

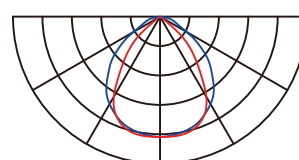

(90°x110°)

DIMENSIONS(mm)

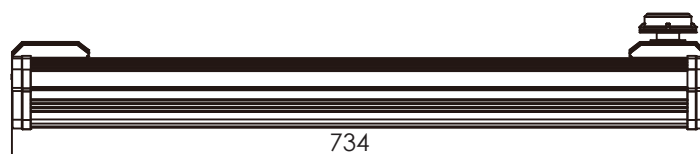

100W (T756) & 150W (T757)

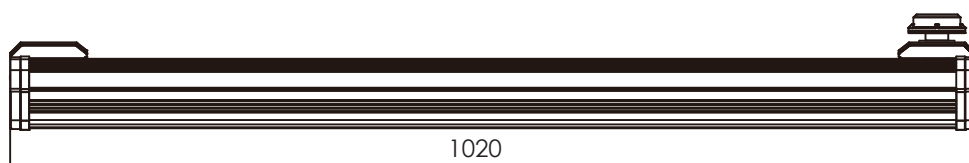
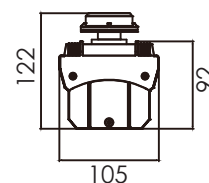

200W (T758)

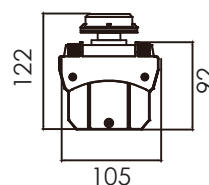

PACKAGE

Power	Carton size (mm)	Qty./Carton	N.W.(KG)	G.W.(KG)
100W & 150W	7090*240*235	4	10.10	10.90
200W	1075*240*235	4	13.40	14.20

CHARACTERISTICS



Built-in Driver

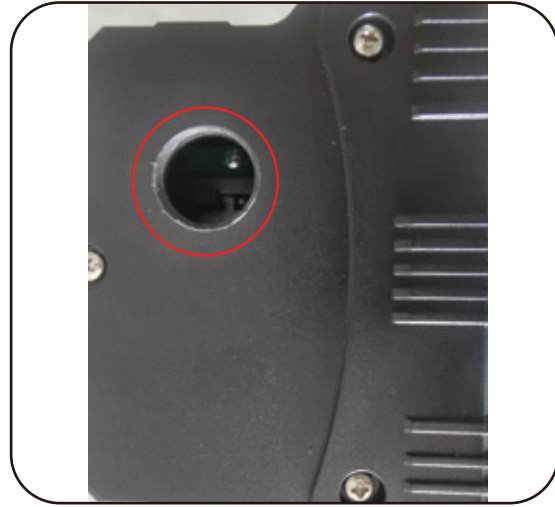

CCT Switch

Remark:

Lumen efficiency base on full lux, rated at 4000K/5000K

DETAIL

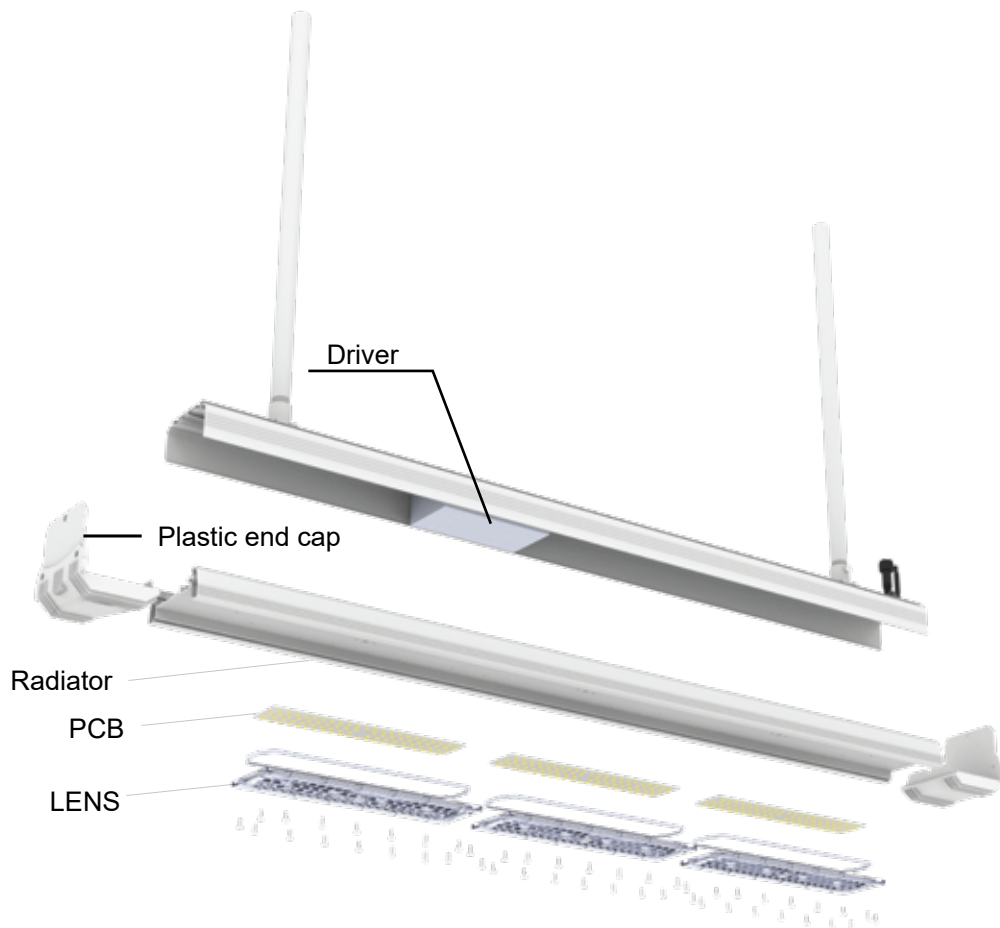

Installation

Existing fittings must be completely removed before installation of a new product. Before removing the existing fitting, carefully note the position of each set of wires.

- Note that the power needs to be isolated/switched off at the fuse board.
- The fixing point(s) selected must be capable of supporting the full weight of the light fitting.

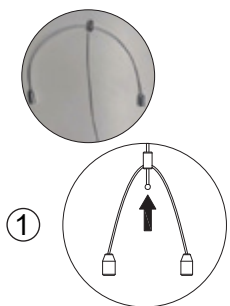
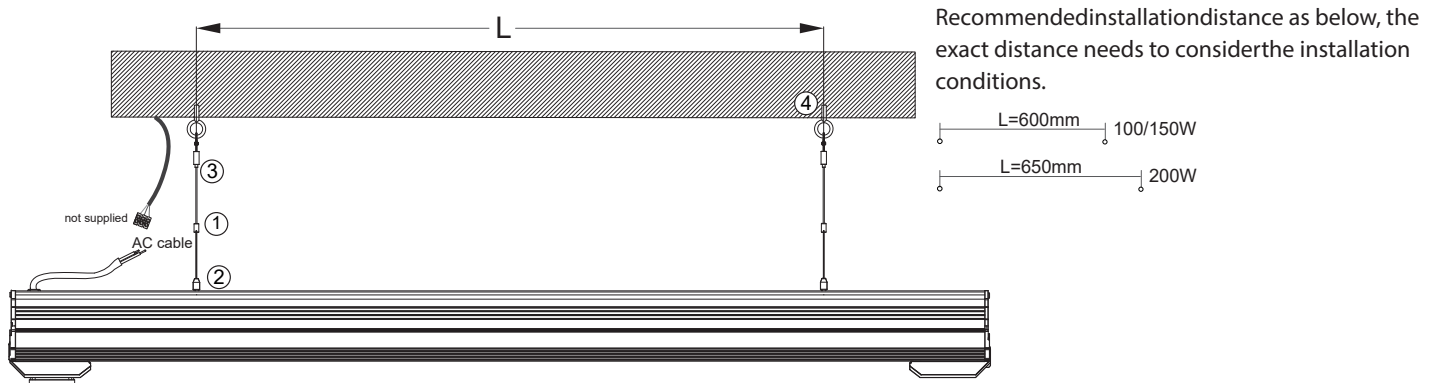

As the picture shows, thread 1 meter of suspension wire through the cylinder.

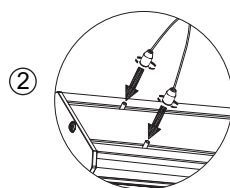

Twist locks into screw on top of light fixture.

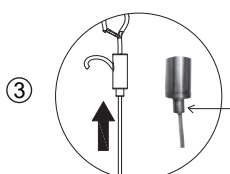

The line that will pass into the cylinder continues to pass under the hook. Ensure the light fitting hanging level. Depress the metal button per direction of arrow to push/pull steel wire simply to adjust the height. (Max. L=1m).

- ④ Determine the installation position, mark and drill the fixing holes on the ceiling for your light fitting. Install a hook (not supplied) solidly. Then hang up the product into the hook solidly. Ensure the light fitting hanging level.

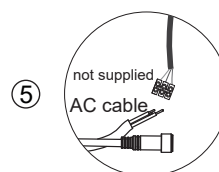
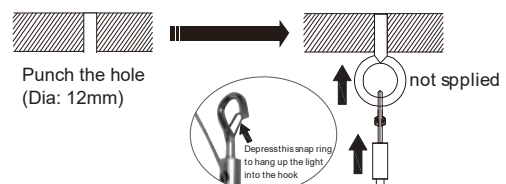

Pull the wire through the hole and connect to the AC100~277V through connection block (not supplied) referring to the wiring diagram.

- ⑥ Replace fuse or circuit breaker and switch on. Your light is now ready for use.

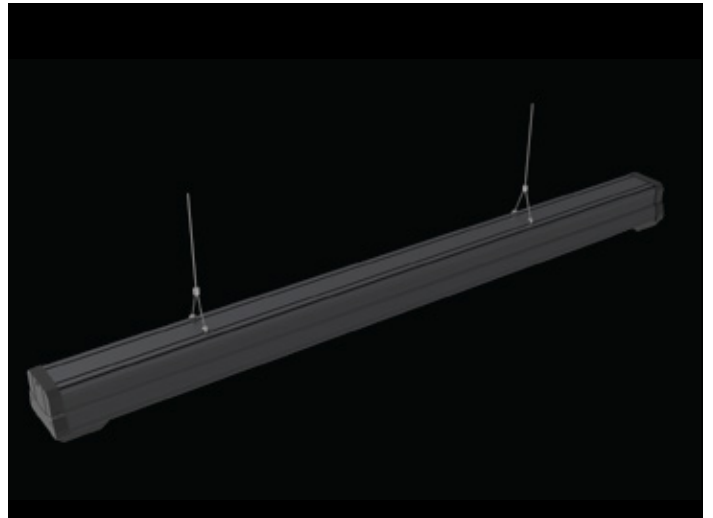

SKU: ACC1089

Surface Mounted Bracket for Linear Highbay Available separately



Stuck? Confused?

Contact our Technical Support team on:

T: +44 (0)1291 446 105 E: support@ener-j.co.uk

Lines are open Mon - Fri (8am to 4pm)