

# T8 LED NANO PLASTIC TUBE 150CMS 22W 4000K



  
**2000LM**  
LUMENS

  
**22W**  
WATTS

  
**270°**

  
**4000K**  
KELVIN

  
**FLICKER  
FREE**

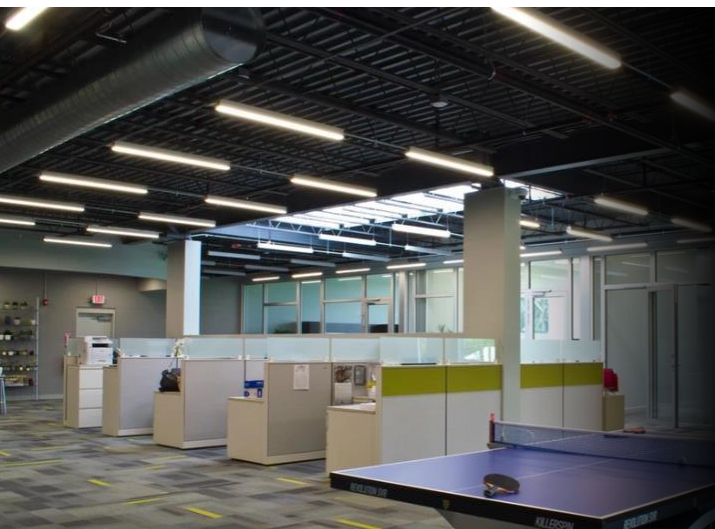

Ideal for basic lighting, such as offices, shopping malls supermarkets, business hall, factories, schools, public transport, underground parking and other places replacement.



### Product Features

- No RF interference, no flickering or noise
- Low lumen decrease
- Nano Plastic cover - no hazardous materials
- Aluminum base for optimal cooling to maximize lifetime
- Built-in isolated, stable and safe led driver
- Certificates: CE, RoHS, LVD

### Wiring Diagram

Method 1 for the LED tube rack



1. Installation with LED tube rack . Cut off the power.
2. The LED tube "L" "N" sides connect directly with power "L" "N".
3. Turn on the LED lighting

Method 2 for the fluorescent tube rack



1. Cut off the power.
2. Remove the fluorescent tube and starter.
3. The LED tube "L" "N" sides connect directly with power "L" "N".
4. Install the LED starter.
5. Turn on the LED lighting

### Technical Specification:

Product Name	:	T8 Nano Plastic LED Tube 150cm
Dimensions	:	26mmx1500mm
LED Quantity	:	120pcs
LED Type	:	SMD 3528
Basis	:	Aluminium
PVC Cover	:	Frosted
Power Consumption	:	22W
Input Voltage	:	175 - 265VAC
Input frequency	:	50~60Hz
Output voltage	:	35 - 40V
Power factor	:	0.88 - 0.98
Luminous Flux	:	2000Lm
Viewing Angle	:	270°C
Colour temperature	:	4000K
Colour rendering index	:	80

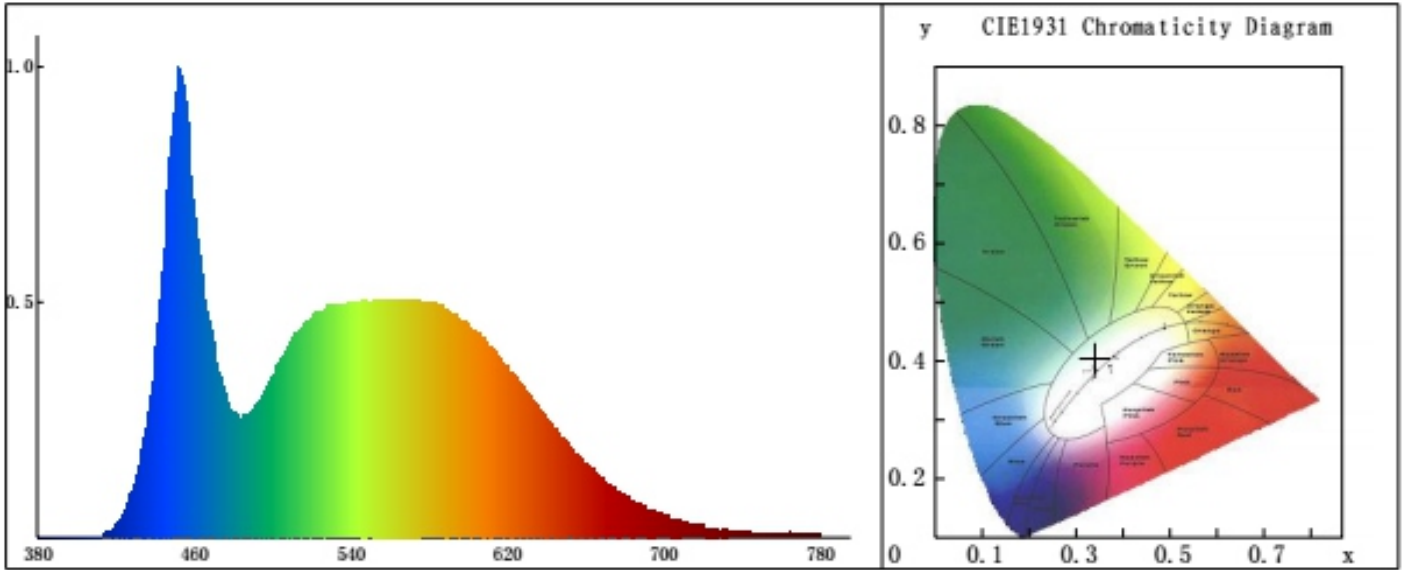

**Product Mark**

---

Product Type	:	T8 1.5M
Temperature	:	01°C
Operator	:	01
Manufacturer	:	SG
Humidity	:	65%
Test Date	:	2017-04-07

---

<b>Colour</b>		<b>Barcode</b>
4000K	:	13144051

---

**Chrome Parameters**

---

Chro. Coord.	:	X = 0.3183
		Y = 0.3391
		U = 0.1979
		V = 0.3163
		DUV = 0.0056
CCT	:	TC = 6159K
Dominant Wave	:	497.8nm
Purity	:	4.7%
R ratio	:	R=13.5
Peak Wave Length	:	452.1nm
Half Width	:	22.7nm
Rending Index	:	Ra = 81.5

---

**Thank you for choosing ENER-J!**

Customer satisfaction is our TOP priority, please let us know how you felt about your experience. Happy? We are so happy that you are pleased with our product. Feel free to express your newfound joy! Share your experience by writing a review.

Not Happy? If you are not fully satisfied with the item you received, have any problems like damages, or questions, please contact us. We typically respond within 24-48 hours.

**Stuck? Confused?**

Contact our Technical Support team on:  
T: +44 (0)2921 252 473 | E: support@ener-j.co.uk  
Lines are open Mon - Fri (8am to 4pm)